

FACT SHEET

UPDATED: 06.28.23

PROJECT STATUS

Project design is 100% complete and staff is pursuing final entitlements and approvals at Planning Commission.

PROJECT BUDGET

The total cost for design and permitting is \$1.77M and has been fully funded by City Council.

The Construction phase is estimated to cost \$16M.

The construction phase is not yet funded. Design is 100% complete.



Verdi Bike and Pedestrian Rail Undercrossing (CS16E)

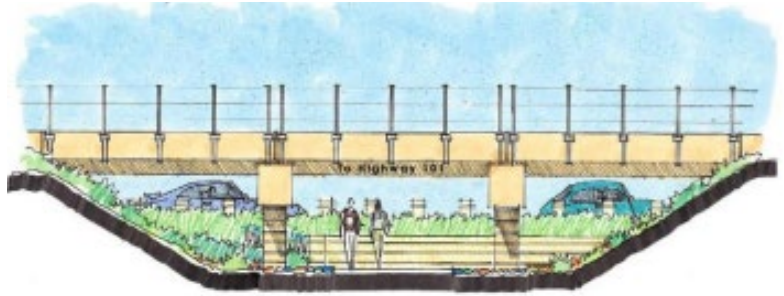

LOOKING WEST THROUGH THE BRIDGE

ABOUT THE PROJECT

Initial design and exploration for a Cardiff area pedestrian rail crossing began in 2015 with a broad examination of alternative rail crossing options and locations in the Montgomery/Verdi Ave. vicinity.

Over time, the project location and scope evolved significantly. With SANDAG's construction of the Cardiff segment of the Coastal Rail Trail, changes in project area grade and drainage led to a change in focus away from an at-grade crossing to a rail undercrossing, which required additional examination and design work, as well as additional environmental analysis, outside agency coordination and project permitting. Over the course of the design progression, the city has executed eight amendments to the project design and scope in order to achieve the best possible solution for the community.

In February 2020, City Council directed staff to proceed with completion of final design and permitting for a pedestrian undercrossing at Verdi Ave. and fully funded the final design phase of the project.

The project supports the Quality Transportation vision of the City's Strategic Plan by providing effective, safe, and easy transportation for all modes of movement and for all demographics.

REVIEW PROCESS

The project was developed in coordination with the Cardiff community, Cardiff 101 Mainstreet Association and CA State Parks. Additional coordination and permitting was conducted with NCTD, SANDAG, FRA and CPUC. Community workshops and wayside horn demonstrations were conducted in 2017 and 2018 during early variations of design. Project alternatives were presented and explored as part of the Coastal Mobility & Livability Study. Here's a link to the April 25, 2017 CMLS workshop that explores various undercrossing concepts at Verdi Ave.: [Community Meeting](#)

City of
ENCINITAS

505 South Vulcan Avenue
Encinitas, CA 92024
760.633.2600 | encinitasca.gov

PROJECT LOCATION AND AMENITIES

The Verdi Rail Undercrossing project will provide a safe pedestrian and bicycle railway crossing for the Cardiff by-the-Sea area of Encinitas and will build a connection between San Elijo Avenue and S. Coast Highway 101, roughly midway between Chesterfield Dr. and Santa Fe Dr.

Trailheads and pathways to the rail undercrossing will be located on San Elijo Ave. at both Verdi Ave. and Liszt Ave.

The undercrossing pathways will intersect and cross the Coastal Rail Trail (CRT) where widened landings will be used to mitigate congestion. An additional stair-free ADA friendly pathway will connect the CRT to San Elijo Ave. at Verdi Ave.

New pedestrian activated RRFB Crosswalks will be installed on San Elijo Ave. at Verdi Ave. and Liszt Ave., and a new pedestrian activated traffic signal is planned for installation at South Coast Highway 101, similar to the Swami's Ped X-ing signal.

The existing CRT path alignment and Verdi drainage feature will be maintained. Consideration was made to layout the paths in such a way as to minimize impact to existing parking areas.

The CRT will remain open during the majority of construction activity, however, during construction of the CRT path intersections and storm drain crossing installation, pedestrians will be temporarily diverted around the project along San Elijo Ave.

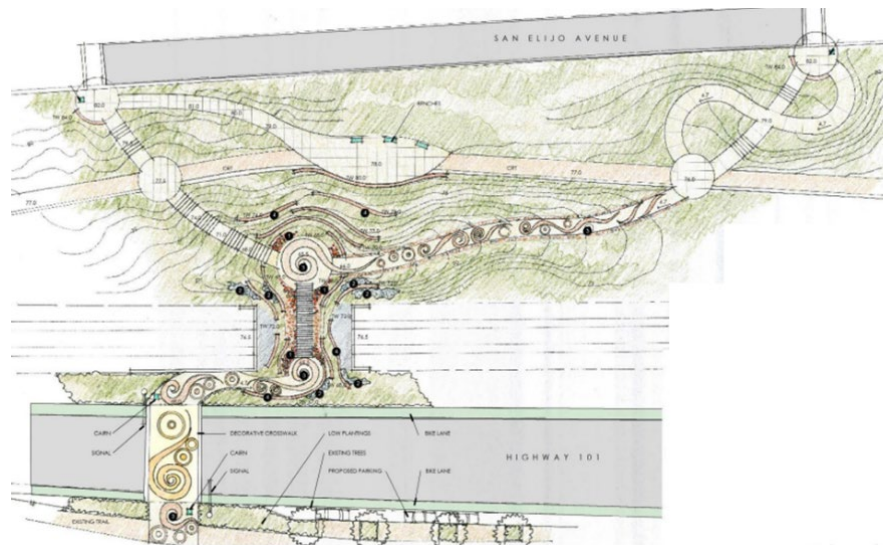
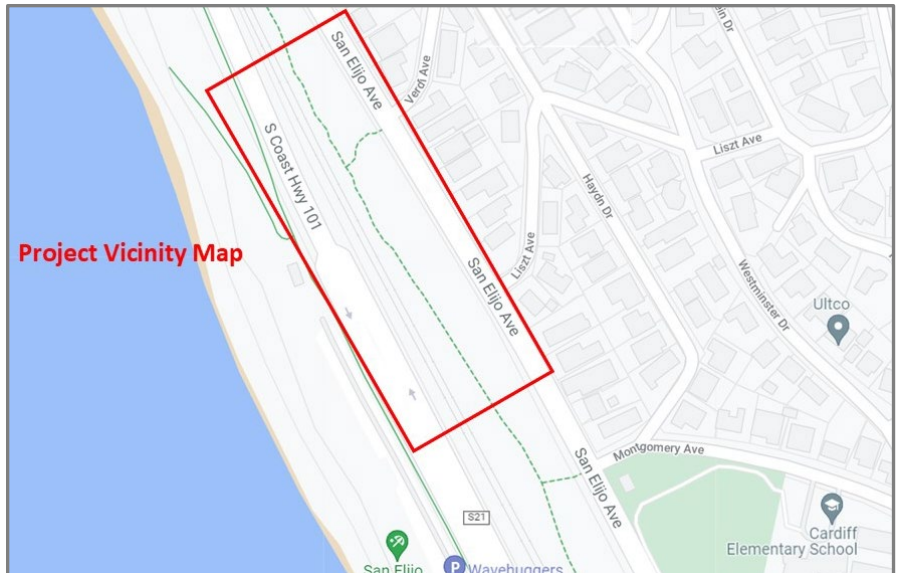

CONTACT US

There are a number of ways the community can stay informed about the project throughout construction:

- **Email Alerts:** Sign up to receive City News and Updates via email alert from the 'I want to' section of the city's website, at: [City Updates](#)
- **Email questions:** Send project questions to Matt Widelski, Principal Engineer at mwidelski@encinitasca.gov or 760-633-2862



City of
ENCINITAS

505 South Vulcan Avenue
Encinitas, CA 92024
760.633.2600 | encinitasca.gov